

How and where do I find a flat?

By looking for a flat yourself:

In big real estate portals,
For example, ImmoWelt or ImmoNet.



In the newspapers



What do the abbreviations mean?

	Deutsch	English
Balk.	Balkon	Balcony
BK	Betriebskosten	Operating cost
DG	Dachgeschoss	Attic floor
DH(H)	Doppelhaus(hälfte)	Semi-detached house
Du.	Dusche	Shower
EBK	Einbauküche	Equipped kitchen
EFH	Einfamilienhaus	Detached house
EG	Erdgeschoss	Ground floor
ELW	Einliegerwohnung	Apartment
Gä.-WC	Gäste-WC	Guest bathroom
Grdst.	Grundstück	Property
HWR	Hauswirtschaftsraum	Laundry room
Kaut.	Kaution	Deposit
Kft.	Komfort	Luxury
KM	Kaltmiete	Cold rent
Mais.	Maisonette	Duplex apartments
MM	Monatsmiete(n)	Monthly rent
MS	Mietsicherheit	Rent Securities
NK	Nebenkosten	Additional costs
NR	Nichtraucher	Non smoker
OG	Obergeschoss	Upstairs
Park.	Parkett	Parquet
Part.	Parterre	Parterre
qm	Quadratmeter	Square meters
REH	Reihenendhaus	Ending townhouse
RMH	Reihenmittelhaus	Middel townhouse
Sout.	Souterrain	Basement

Support in looking for a flat

Stadt Eutin Fachbereich Sozialarbeit

Contact Person: Frau Koch

Address: Markt 1, 23701 Eutin

Phone: 04521 793 261

E-mail: d.koch@eutin.de

Housing Societies in Eutin

Wohnungsbaugesellschaft Ostholstein mbH

Address: Seestraße 7, 23701 Eutin

Phone: 04521 7900-17 and 7900-23

Bau- u. Siedlungsgenossenschaft Eutin eG

Address: Ferdinand-Tönnies-Straße 8,
23701 Eutin

Phone: 04521 2129 and 4462

Wankendorfer Baugenossenschaft f. Schleswig-Holstein eG, Stadtbüro Plön

Address: Lübecker Str. 24 - 26, 24306 Plön

Phone: 04521 78475

Unternehmensgruppe Semmelhaack

Address: Kalteweide 85, 25335 Elmshorn

Phone: 04121 4874955

Stand: 01/2023

Standard Values for proper lease rental charges within SGB II or SGB XII-Cover

(Basic rent + additional Cold Costs)

1 Person	up to 50m ²	431,00€
2 Person	up to 60m ²	496,20€
3 Person	up to 75m ²	597,00€
4 Person	up to 85m ²	744,30€
5 Person	up to 95m ²	879,90€
Every further person	+ 10m ²	+83,80€

+ Heating

Certificate of eligibility to public housing/accommodation

The certificate of eligibility to public housing/accommodation is an official certification in Germany, which helps the tenant to prove that he/she is eligible to get a flat which is promoted by public funds (Sozialwohnung).

1) To get the application form:

Bürgerbüro Stadt Eutin

Markt 1, 23701 Eutin

2) Examination thorough the Housing assistance department:

Wohngeldstelle

Elisabethstraße 16-18

How to look for and find a flat



Info! Tipps!

Money from Social Security Office or Jobcenter

Go to the official department, which provides your financial assistance with **YOUR UNSIGNED LEASE CONTRACT** and let the rental transfer authorized!

Rent deposit is carried by the relevant institution under certain conditions. These conditions should be cleared up beforehand!

When signing the lease contract

You should pay attention to:



- Graduated rent. Does the rent automatically rise?
- How high the additional costs are. Especially the heating costs!
- How high the deposit is.
- If there is a minimum term.
- Obligation for renovation

Furniture, Dishes etc.



You can take some stuff from public residential property (depending on the facility). What you exactly are allowed to take could be asked in integration office (Integrationsbüro) and Regulatory Authority (Ordnungsamt). Part of the initial equipment was given here.

Money from Social Security Office or Jobcenter:

File the application for initial equipment. The result could take some time, since the authorities visit the flat as a rule, before something is authorized.

Employee/ Income:

You must pay the furniture on your own.

You could buy in:

Sozialkaufhaus BQOH, Ohmstraße 7, 23701 Eutin

Which documents do you need?

Flat proposal

Social Security Office and Jobcenter require as a rule a flat proposal, which shows the rent, additional costs and other relevant points. The relevant institution must approve this proposal **BEFORE SIGNING THE LEASE CONTRACT**.

Certificate of eligibility to public housing/accommodation

Certificate of eligibility to public housing/accommodation, which makes one authorized for renting a public housing, is helpful or sometimes also necessary.

SCHUFA-Credit Report

For the landlord

Confirmation of cost covering from the relevant institution or certificate of income (if need be with contract of employment)

For the landlord

Copy of the residence title for specific purposes or residence allowance

For the landlord

If necessary additional documents could be required.

IMPORTANT

Proof of when and where was searched!

The job center may require that an overview be provided, showing when and where to look for a home of their own.

Therefore, always keep an overview!

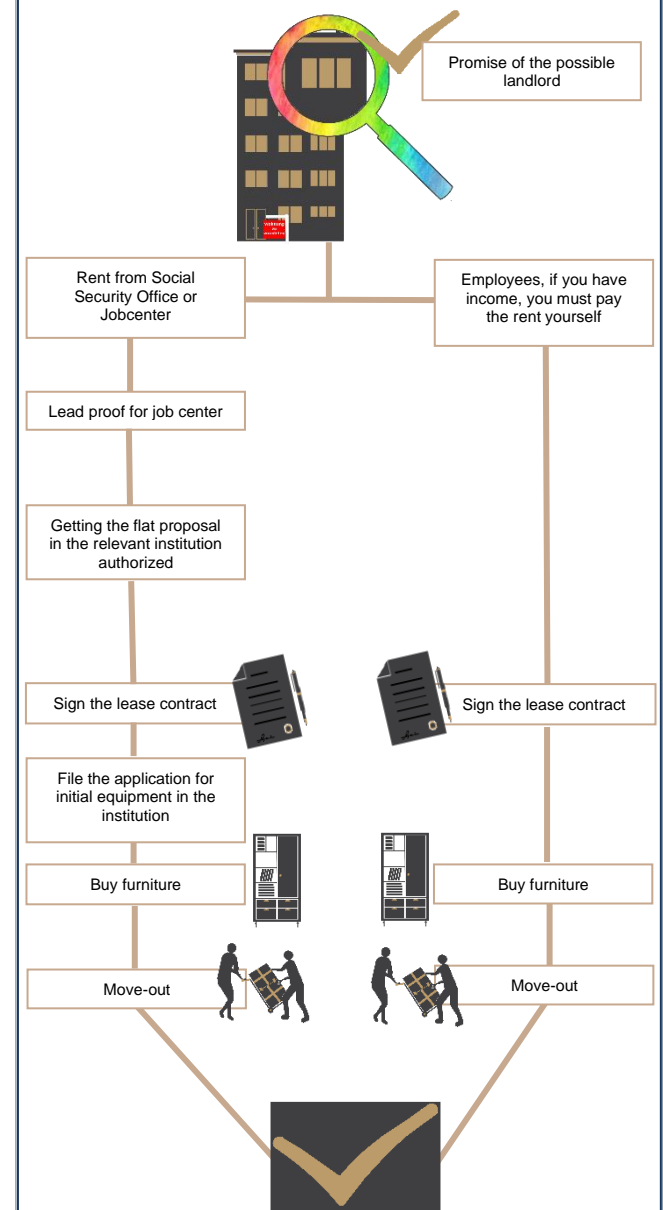

For more information visit our Website:

<http://www.vg-eutin-suesel.de/Stadt-Eutin/Service/Flüchtlingshilfe>

Flyer developed by

Integrationsbüro der Stadt Eutin
Carl-Maria-von-Weber-Straße 20
23701 Eutin

Contact person:

integrationsbuero@eutin.de
04521 793 282